

Industrial Park

# McKenzie Industrial Business Park

Red Deer, Alberta

Proudly Owned and Professionally Managed by



## Locator Map

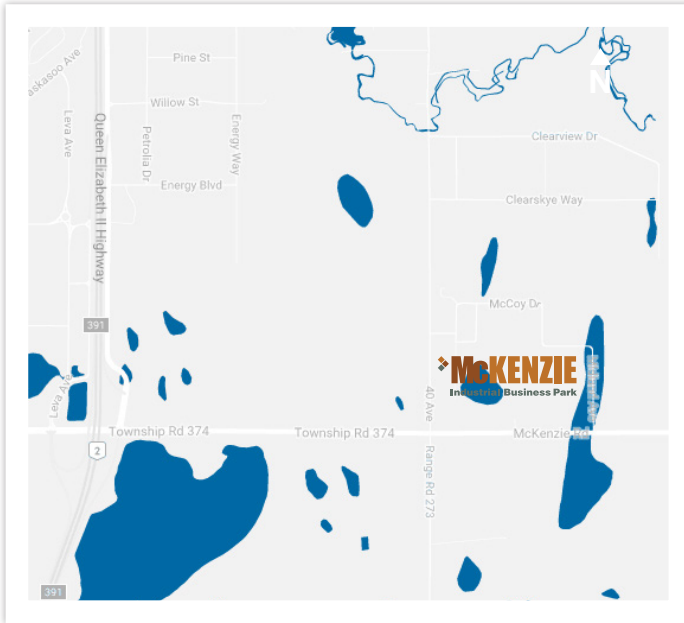

## Property Features

Location Proximity	Easy North/South access to the Queen Elizabeth II Highway
Leasable Space Remaining	11,700 SF
Size	8.4 Acres (of 160)
Bay Size	4,000 SF and up
Zoning	MI - Medium Industrial BSI - Business Service Industrial
Power	<ul style="list-style-type: none"> <li>• 200 amps/bay @ 120/208 V or</li> <li>• 70 amps/bay @ 347/600 V</li> </ul>
Parking	<ul style="list-style-type: none"> <li>• 102 stalls</li> </ul>
Yard Space Available	<ul style="list-style-type: none"> <li>• 61,562 SF (1.41 acres)</li> </ul>
Building Height	28' - 0"



# Development Maps

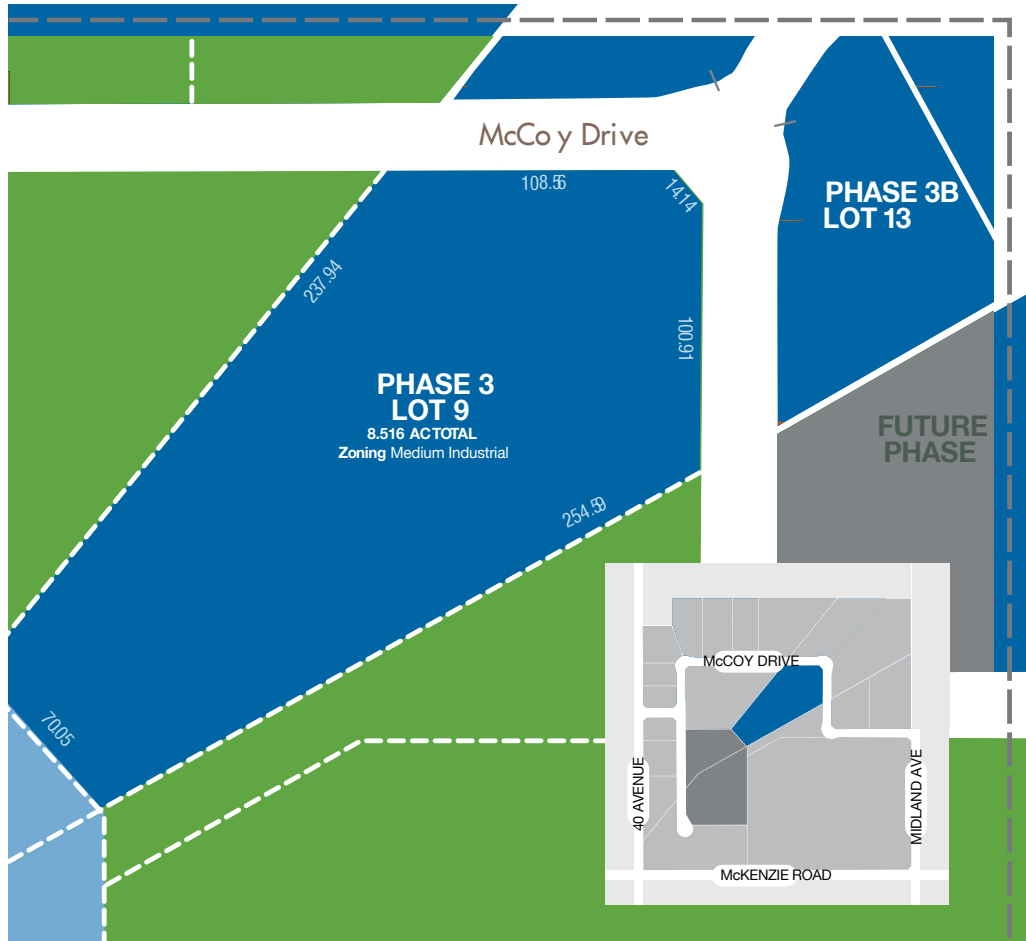
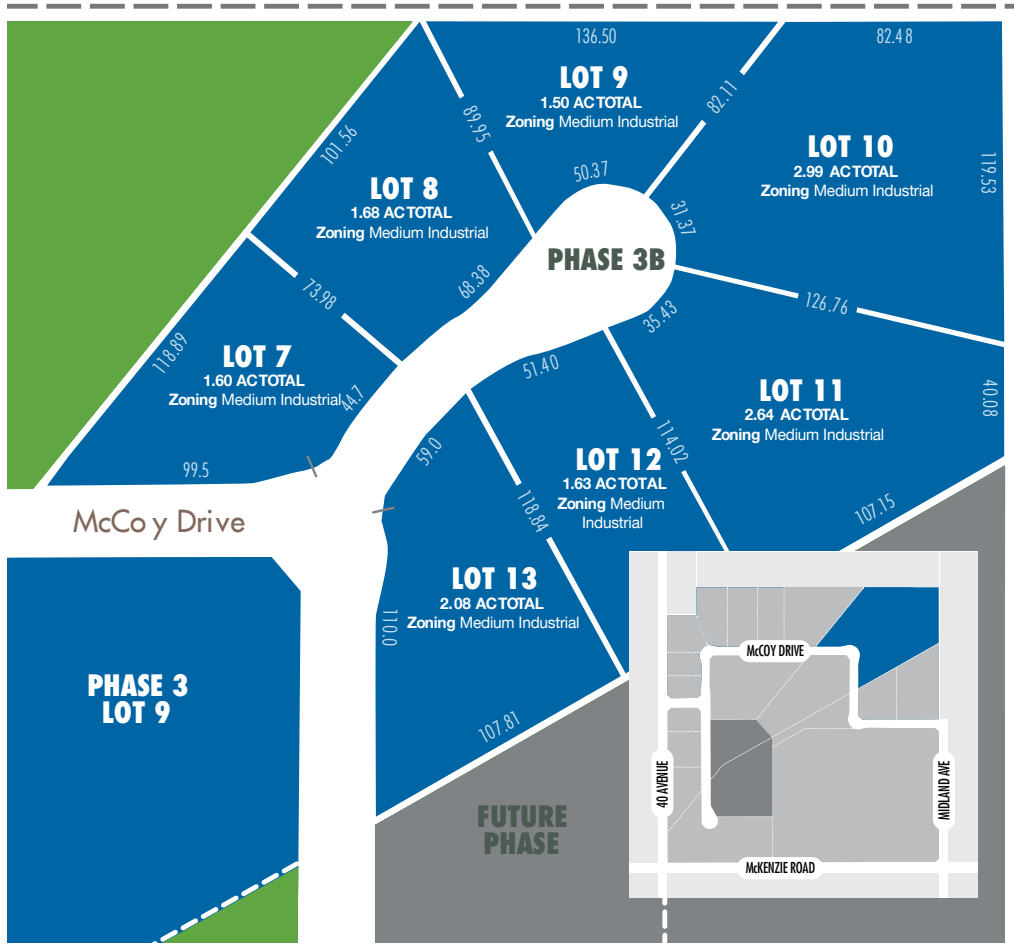

# McKenzie Industrial Business Park



For additional information, please contact:

**Nola DeCecco**  
780.945.4812  
nececco@melcor.ca

**MELCOR**

Suite 900, 10310 Jasper Avenue  
Edmonton, AB T5J 1Y8  
p| 780.423.6931 f| 780.426.1796