

Business Campus

The Village at Blackmud Creek

Ellerslie Road & Calgary Trail, Edmonton AB

Proudly Owned and Professionally Managed by

MELCOR

Locator Map

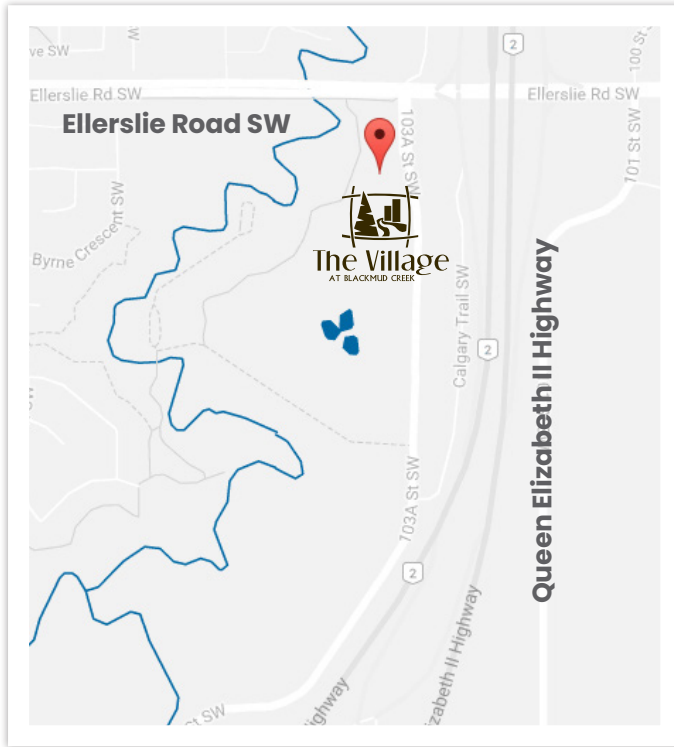

Property Features

| | |
|-----------------------|--|
| Intersection | Ellerslie Road & Calgary Trail |
| Total Leasable Area | 725,000 SF |
| 2026 Operating Costs | Office - \$21.50/sf Retail - \$14.58/sf |
| Drive Times | <ul style="list-style-type: none">• Downtown: 20 mins• Edmonton West: 15 mins• Leduc & Nisku: 15 mins• International Airport: 14 mins |
| Current Opportunities | <ul style="list-style-type: none">• Office• Retail |
| Major Tenants | <ul style="list-style-type: none">• RBC Dominion Securities• Fountain Tire• Kids & Company• CPA Western School of Business |

Aerial Map



MELCOR

Site Plan

The Village at Blackmud Creek



For additional information, please contact:

Nathan Wanchulak
 780.945.4657
 nwanchulak@melcor.ca

Sauna Hazlett
 780.945.2797
 shazlett@melcor.ca

MELCOR

Suite 900, 10310 Jasper Avenue
 Edmonton, AB T5J 1Y8
 p| 780.423.6931 f| 780.426.1796
 www.MelcorREIT.ca

The Village at Blackmud Creek Fountain Tire Place



Main Floor Plan

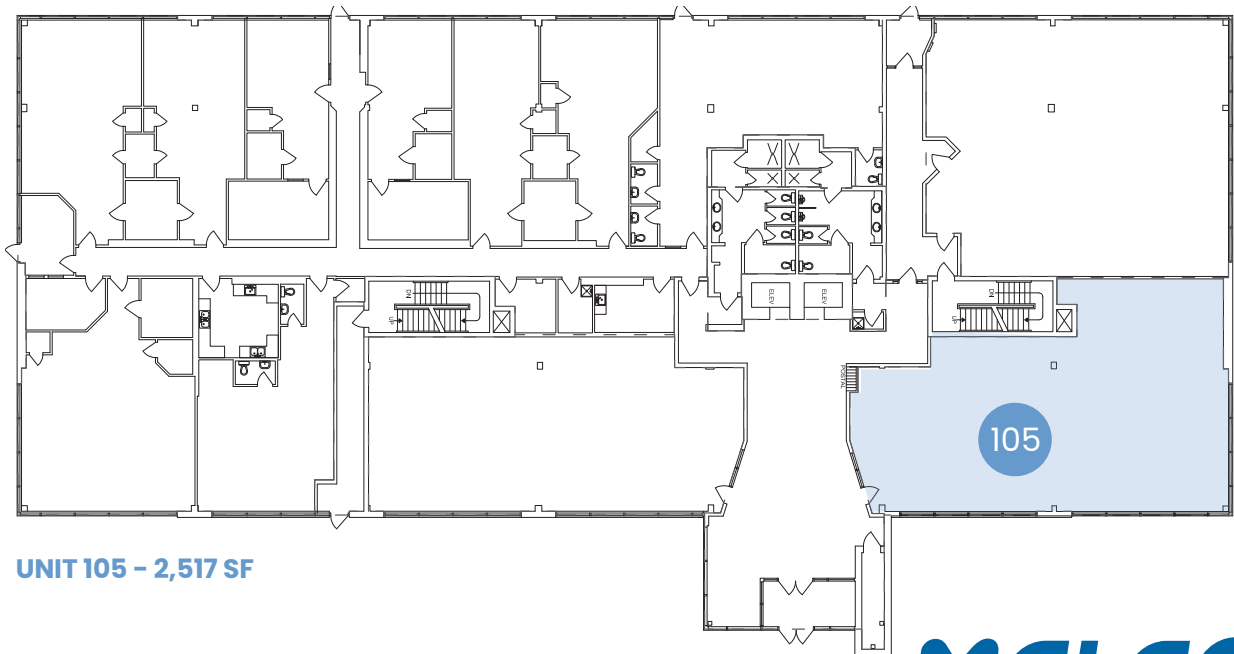

UNIT 105 - 2,517 SF

MELCOR

For additional information, please contact:

Nathan Wanchulak
780.945.4657
nwanchulak@melcor.ca

Sauna Hazlett
780.945.2797
shazlett@melcor.ca

Suite 900, 10310 Jasper Avenue
Edmonton, AB T5J 1Y8
p| 780.423.6931 f| 780.426.1796
www.MelcorREIT.ca

www.Melcor.ca

MELCOR

The Village at Blackmud Creek

RBC Building



Main Floor Plan

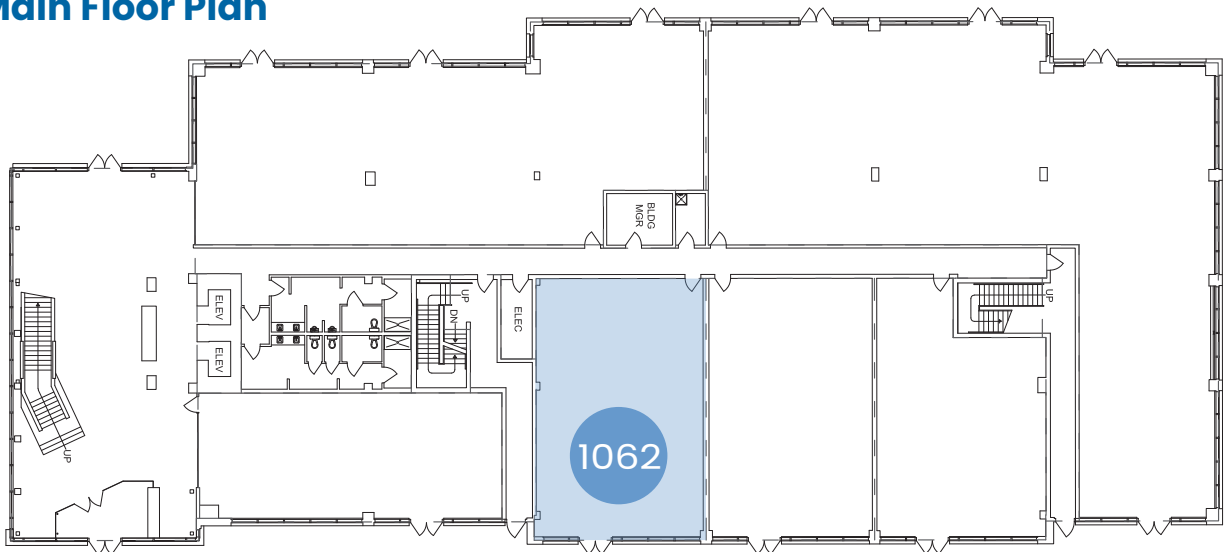

UNIT 1062 - 1,838 SF

For additional information, please contact:

Nathan Wanchulak

780.945.4657

nwanchulak@melcor.ca

Shauna Hazlett

780.945.2797

shazlett@melcor.ca

MELCOR

Suite 900, 10310 Jasper Avenue
Edmonton, AB T5J 1Y8
p| 780.423.6931 f| 780.426.1796
www.MelcorREIT.ca

WWW.MELCOR.CA

MELCOR

The Village at Blackmud Creek

CRU 1 Building



Main Floor Plan

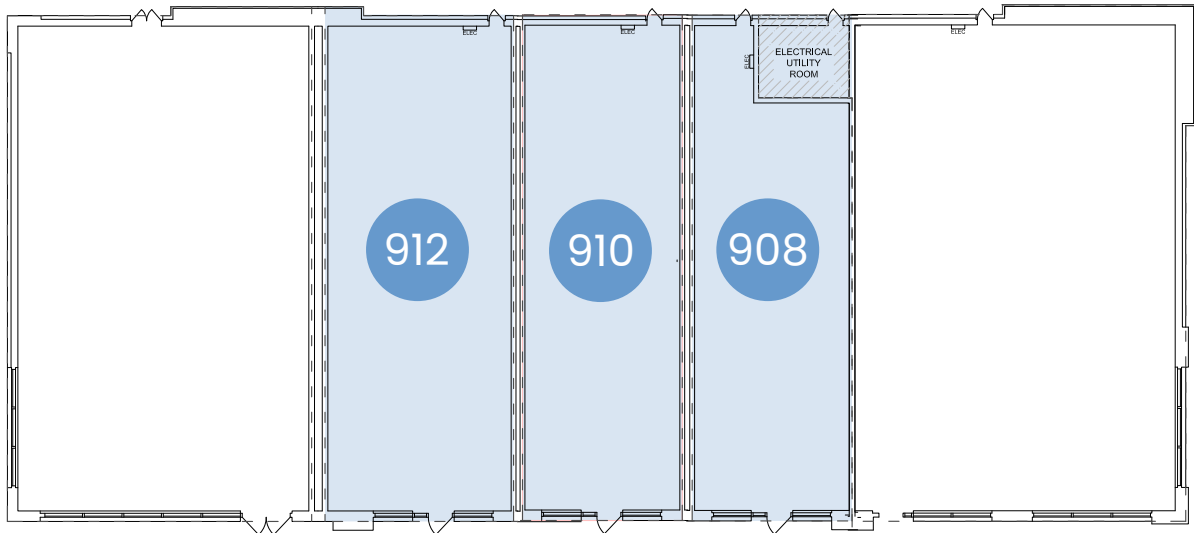

UNIT 908 - 1,159 SF

UNIT 910 - 1,238 SF

UNIT 912 - 1,519 SF

For additional information, please contact:

Nathan Wanchulak

780.945.4657

nwanchulak@melcor.ca

Sauna Hazlett

780.945.2797

shazlett@melcor.ca

MELCOR

Suite 900, 10310 Jasper Avenue

Edmonton, AB T5J 1Y8

p| 780.423.6931 f| 780.426.1796

www.MelcorREIT.ca