



RETAIL SPACE



# ROSENTHAL SECORD COMMERCIAL

215 Street | 92 Avenue NW  
Edmonton, AB

## AREA DEMOGRAPHICS:

Household  
Income:

Primary: \$104,559

Traffic Count:

92 Avenue: 6,100  
Winterburn Rd/215 ST: 16,100

Trade Area  
Population:

Primary: 26,179  
Secondary: 43,700

*New retail development serving  
west Edmonton*

LOCATOR MAP ▼



## POPULATION:

- A. Lewis Estates: 18,691\*
- B. Rosenthal: 12,570\*
- C. Secord: 13,549\*

*\*projected*

## ROADWAYS:

- 1. 92 Avenue
- 2. Winterburn Rd/215 Street
- 3. 231 Street

**MELCOR**

**CONTACT**

Scott Sowinski  
+1.780.945.2795  
ssowinski@melcor.ca



@melcordev  
@LandlordofChoice  
www.melcor.ca

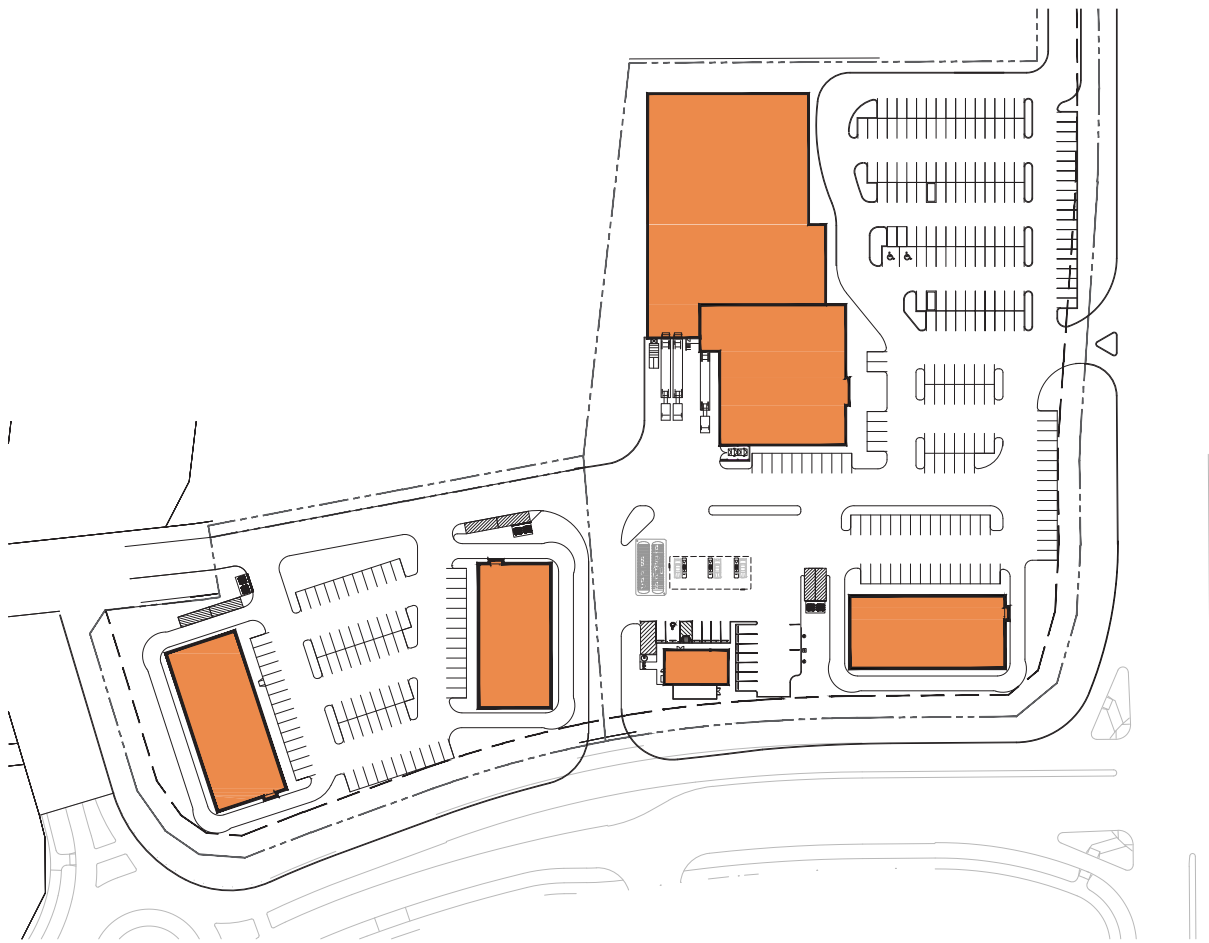

■ AVAILABLE   
 ■ OCCUPIED   
 ■ PENDING

▲ SECORD SITEPLAN

## ROSENTHAL-SECORD

### CURRENT OPPORTUNITIES:

Anchor, CRU, PAD, Gas Bar

### SITE HIGHLIGHTS:

Intersection:	215 Street 92 Avenue NW
GLA	200,000 sf
Total Acres	17.67
Signage Opportunities	Pylon (\$)



*Master-planned and developed by Melcor*

**MELCOR**

**CONTACT**

Scott Sowinski  
 +1.780.945.2795  
 ssowinski@melcor.ca



@melcordev  
 @LandlordofChoice  
 www.melcor.ca